

HUGA

TÜRELEMENTE
OBJEKT
WOHNEN



DESIGNER DOORS

white
paint finish



Contents



4 Designer door wave 1

6 Designer door wave 2



8 Door frames

9 FORMA-edge

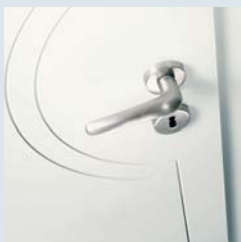

10 Designer door signum



14 Designer door sueno 1/2



16 Glazing

New for all HUGA designer doors: white surface finish

Their new white paint finish is HUGA's latest innovation – a perfectly smooth overall surface finish produced by a single dip. HUGA's white paint finish incorporates an attractive appearance and touch with a high degree of functionality. This combination makes HUGA white paint finish a favourite for exquisite interior decors. Developed in-house. Various

layers of surface material and mouldings are combined in a series of successive steps. The result is impressive. There is no limit to what white can do. HUGA white paint finish refines all styles of designer door. Selected examples can be seen on the following pages.



01 Designer door wave HUGA white paint finish version 1, 2430 clear glass motive laser-engraved 02 Designer door wave HUGA white paint finish version 1, 2410 clear glass motive matt sand-blasted 03 Detail 2430 laser-engraved *Milieu image* right: Designer door wave HUGA white paint finish version 1

Designer door wave 1



Designer door wave 1

wave

Whether smooth or with a lively textured appearance, HUGA's white paint finish refines all the surfaces of their new **wave** series designer doors. The advantages of the white paint from a single dip are particularly obvious where the plane rails and stiles meet the finely rippled **wave** décor. Even after long-term daily usage, the edges show no real signs of wear and

tear. Smooth areas shimmer and even finetextures retain their distinctive character. All **wave 1** designer doors can be supplied with ATLANTA glazing. **wave** & HUGA white paint finish: diverse in appearance – outstanding in quality.



01

wave 1

01 Designer door wave HUGA white paint finish, version 1 [Milieu image](#) right: Designer door wave HUGA white paint finish, version 2

Designer door wave 2



Door frames

HUGA Moulded Frames

When looking at a door it is not just the door leaf which is important, but the general impression given by the door, the frame and their coherence to the wall. Only a fully coordinated frame can set the door off perfectly, and also act as a congruous link to the wall.

Moulded frame 60mm/80mm

The tried and trusted 60mm – the magic 80mm for renovations. In addition to their popular 60mm moulded frame, HUGA is now offering an 80mm version. This new frame covers the wall

more substantially and is ideal for renovation purposes. If wallpaper edges have been damaged for instance, the 80mm frame covers up the ugly edges simply and neatly.

Elipse moulded frame

The ideal combination of Italian flair and well-conceived functionality. The 70mm convex surface surrounds the door with a really balanced form of lines and enhances the interplay of door, frame and wall. The Elipse door frame does not simply surround the door, it acts as a visual mediator, at the same time supporting the function of the door perfectly.

Provile moulded frame

Bold design can give a lift to both the apartment and the workplace. HUGA's new Provile frame is a trend-setter which is not content to simply lurk in the background, but projects itself as an equal partner to the door. This mutual cooperation of door leaf and eye-catching rippled frame is setting charming new directions for everyday home life and the sophisticated working environment.

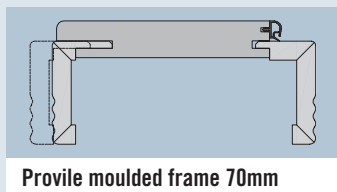
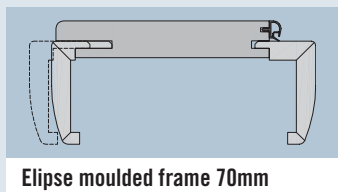
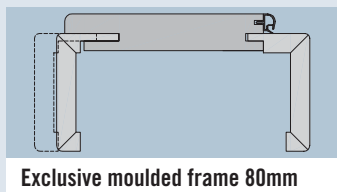
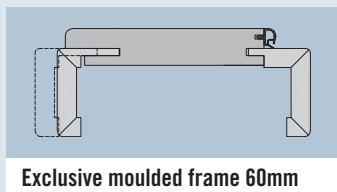

Exclusive moulded frame 60mm

Exclusive moulded frame 80mm

Elipse moulded frame 70mm

Provile moulded frame 70mm

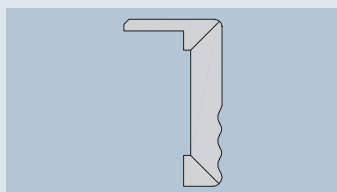
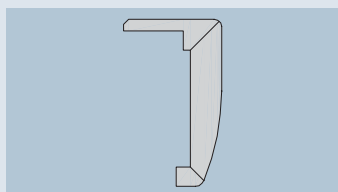
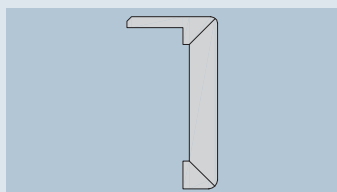
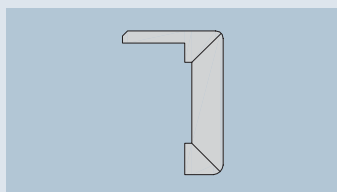

Exclusive architrave 60mm

Exclusive architrave 80mm

Elipse architrave 70mm

Provile architrave 70mm

FORMA edge

FORMA edge HUGA white paint finish

The HUGA white paint finish door combines both beauty of form and a timelessly-elegant appearance. Using the latest postforming technology HUGA is setting new trends down to the smallest detail. The edges of the HUGA white paint finish door are rounded as if from a single dip. **Matching frame – DURAT exclusive white paint décor frame.** The jambs of the exclusive HUGA moulded frame are also “postformed”. The rounded architraves on the frames and the white postformed doors are perfectly matched. The perfect rounded element for residential and commercial use.

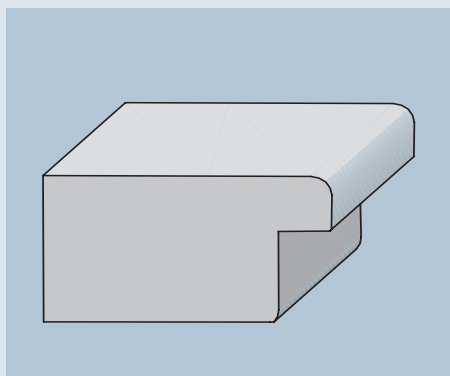

Formation of edges of the door leaf

FORMA edge

SF-10



Detail FORMA HUGA white paint finish

SF-10

signum

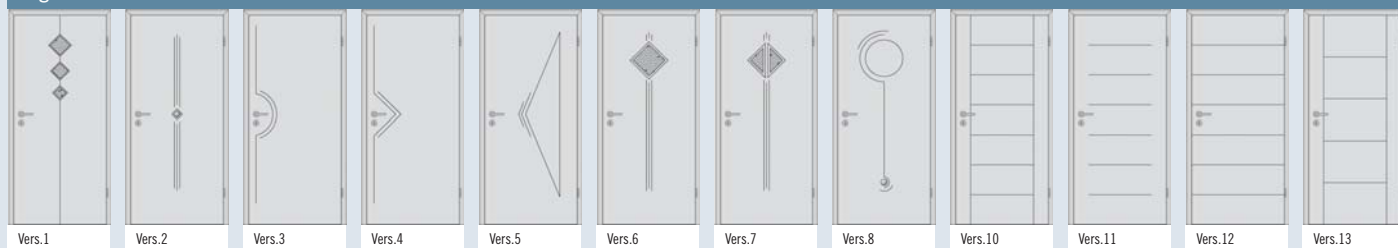

signum

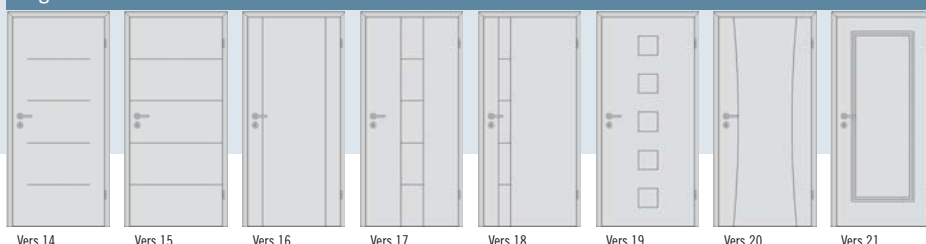

wave

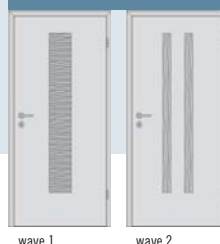

sueno





01

Vers.21



02

Vers.3

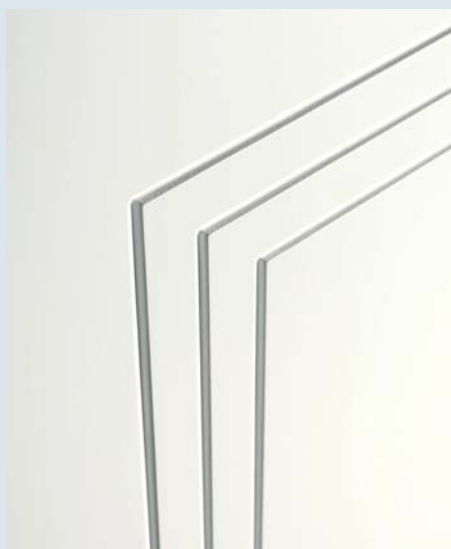

03

Vers.21



04

Vers.3



01 signum HUGA white paint finish, version 21 02 signum HUGA white paint finish, version 3 03 Detail signum HUGA white paint finish grooving, version 21 04 Detail signum HUGA white paint finish grooving, version 3 **Milieu image** left: Designer door sueno 1 HUGA white paint finish, GS 035 clear glass motive matt sand-blasted; right: Designer door signum HUGA white paint finish, version 13

Designer door signum





signum

Flawless edges in particular show up the quality of HUGA's white paint finish. The **signum** designer door opens a new and extremely varied world of form. Fine V-grooves give the door leaf its own individual design – either selected from HUGA's wide range or custom-made. Virtually anything is possible. Here too, the HUGA white paint finish shows that it has more to offer from a visual, touch and functional

point of view. The finish completed in a single step guarantees an absolutely uniform surface right down to the grooved edges, including all functional characteristics. This is why signum designs can offer even more options even when special features are required. **signum** and HUGA white paint finish: diverse in appearance – distinctive in quality.

01 signum HUGA white paint finish, version 10 02 signum HUGA white paint finish, version 13 03 signum HUGA white paint finish, version 16 04 signum HUGA white paint finish, version 2 05 signum HUGA white paint finish, version 19 06 signum HUGA white paint finish, version 18 07 signum HUGA white paint finish, version 11 08 signum HUGA white paint finish, version 20 09 signum HUGA white paint finish, version 15 10 signum HUGA white paint finish, version 12 11 signum HUGA white paint finish, version 5 **Milieu image** left: signum HUGA white paint finish, version 15; right: signum HUGA white paint finish, version 14

Designer door signum



sueno

Glass, plenty of light & HUGA white paint finish – the modern but timeless ambience for a feeling of well-being. **sueno** combines rails and stiles with glazing in two different styles: **sueno 1** with its popular, straight-cut friezes. **sueno 2** with the innovative rippled friezes. The HUGA white paint surface finish combines frieze and glazing while retaining the full functionality and appearance of the door. The absolutely uniform finish of the friezes goes perfectly with the large areas of glass, bringing light and a feeling of space into any doorway. **sueno** and HUGA white paint finish: versatile in use – exceptional in quality.



01

sueno 1



05



02

sueno 1



03

sueno 2



04

sueno 2

01 sueno 1 HUGA white paint finish, GS 035 clear glass motive matt sand-blasted 02 sueno 1 HUGA white paint finish, GS 035 matt glass sand-blasted motive clear 03 sueno 2 HUGA white paint finish, GS 035 clear glass motive matt sand-blasted 04 sueno 2 HUGA white paint finish, GS 035 matt glass sand-blasted motive clear 05 Detail sueno HUGA white paint finish, top of door [Milieu image](#) left: sueno 2 HUGA white paint finish, clear glass sand-blasted motive matt GS 035; right: sueno 2 HUGA white paint finish, matt glass sand-blasted motive clear GS 035 negative

Designer door sueno



Types of Glass

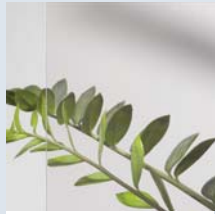

Float white [4|8|10mm]

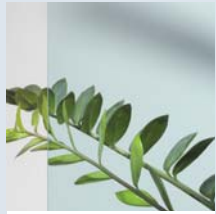

Float green [4|8|10mm]

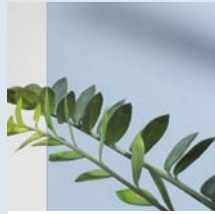

Float blue [4|8|10 mm]

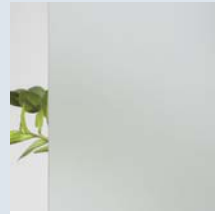

Satinato white [4|8|10mm]

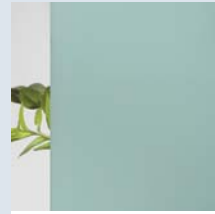

Satinato green [6|8|10mm]

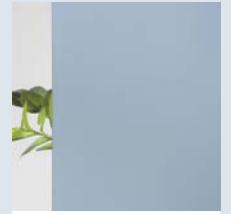

Satinato blue [6|8mm]

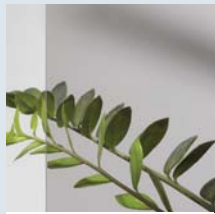

Parsol grey [4|8|10mm]

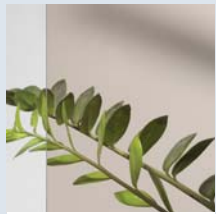

Parsol bronze [4|8|10mm]



Masterligne white [4|8mm]

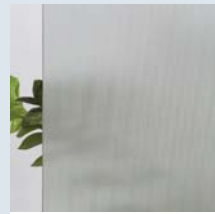

Masterpoint white [4|8mm]



Master Carree [4|8|10mm]



Listral 200 white [4|8|10mm]

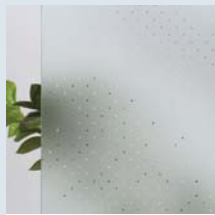

Pave white [5|8mm]



Pave blue [5|8mm]



Uadi white [5|8mm]

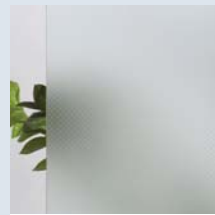

Punto white [5|8mm]

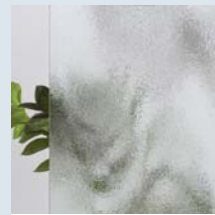

Chinchilla white [4|8mm]



Chinchilla bronze [4|8mm]



Baroque white [4mm]



Madeira 176 bronze [4|8mm]

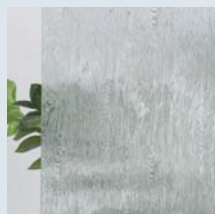

Madeira 176 white [4|8mm]



Masterlenz white [4|8mm]



Ornament 502 white [4mm]



Matt glass [4|8|10mm]

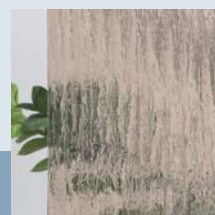

Silvit 178 bronze [4|8mm]

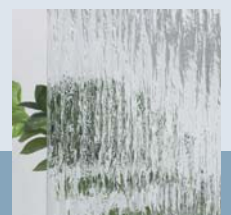

Silvit 178 white [4|8|10mm]

gestaltende Die Farben der abgebildeten Produkte dieser Publikation können reproduktionsbedingt vom Original abweichen. Änderungen, die dem Fortschritt dienen, behalten wir uns vor.

Your specialist for sales and consultation

HUGA · Hubert Gaisendrees GmbH & Co. KG

PO Box 4165 · D-33275 Gütersloh · tel: +49(0)5241.973-0 · fax: +49(0)5241.973160
www.huga.de · verkauf@huga.de