



# Installation instructions

06 / 2005 V1.1

## Standard door

### Contents

Basic factors

Mounting specifications

Mounting and adjusting the door

Mounting the fittings

Notes and recommendations

Maintenance of door elements

Further information on ‚Interior Doors‘

**HUGA**

TÜRELEMENTE  
OBJEKT  
WOHNEN

## 1. Basic factors

The mounting of doors and frames have a great influence on the entire element. Therefore please observe the installation instructions for the frame and the ‚Hints and Recommendations‘ at the end of these installation instructions. If you follow all the points, you'll have many years of troublefree service from your HUGA door. With functional elements, it is also important that you follow the additional installation instructions provided, as the functions (e.g. fireproofing, smokeproofing and burglar-proofing) depend on correct installation

## 2. Mounting specifications

### 2.1 Check the location where the frame is to be installed

- Is the opening direction the same as the frame?
- Are the measurements appropriate for the frame?
- Must any building regulations be observed?

### 2.2 Included in delivery

„Check that the contents of the carton are complete, functional and undamaged; any queries should be dealt with before installation.“

Door leaf with integrated lock (e.g. single tumbler lock with key)

- and hinge components (with V 0026 hinges the hinge pins are in the upper door rebate)

- If appropriate, retractable floor seal or other accessories

### 2.3 Tool

Tools for mounting the door leaves

- Screwdriver
- Allen key (Inbus) size 5
- Metal file (if needed)

Tools for mounting the fittings:

- Screwdriver
- Drill with drill bit
- Other tools if necessary

## 3. Mounting and adjusting the door

### 3.1 Preparation

If necessary, loosely screw in the hinges before hanging the door in the frame. The clearance between hinge reinforcement and door edge should be approx. 1-2 mm, and the frame rebate clearance approx. 3.5 mm on 3 sides.

Tolerances could occur (frame, door leaf and location) which can lead to permissible variations in dimension. According to DIN 18101, the maximum approved floor clearance (door leaf - finished floor) is 10 mm. Please bear this in mind if shortening the frame. If you shorten the door leaf, the edge must be chamfered so

that the top layer does not tear. On timber doors, the chamfer should be sealed with lacquer or other suitable material!

### 3.2 Adjusting the hinges and striking plate

Hang the door leaf in the frame and check functioning. If necessary correct adjustment.

- To change the pressure of the door leaf on the frame, you can loosen the hinge washers (frame part) with an Allen screw in the frame rebate and adjust accordingly. In this way the pressure of the door on the seal can be changed. The door should fit against the frame seal as evenly as possible on all three sides, without squeezing.

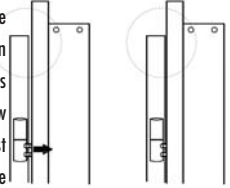

- The hinge components (door part) can be twisted in and out to adjust the position of the door leaf in the frame. The door leaf can be lifted or lowered on the lock side by adjusting unevenly.

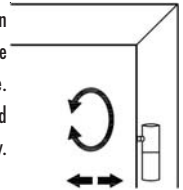

- „The so-called „filing catch““ is to be found on the striking plates. This is designed to retouch the door leaf by filing, to adapt it to any manufacturing, building and mounting tolerances, allowing the door to close smoothly. This is a normal part of installation and is not grounds for complaint.“

### 3.3 Adjusting the floor seal

If your door has a floor seal, adjust this in the door rebate using the pressure screw, so that the sealing lips press lightly on the finished floor when the door is closed.



If applicable, watch the position of the pressure screws in the door rebate.

Avoid contact pressure on the floor! A high contact pressure (premature retraction of the seal) leads to increased wear and tear on the sealing profile, the mechanics and the mounting. A seal is only as good as the floor. Where there is unevenness, carpet or tiles, appropriate thresholds should be used. Please also see the separate mounting instructions.

#### 4. Mounting the fittings

Please refer to the individual steps in the mounting instructions of the fittings manufacturer.

All fittings components which are constantly in use should be regularly checked and lubricated if necessary. This includes latch, bolt and hinges (hinge components- and washers) (but not maintenance-free hinges, where metal works against plastic). A lack of maintenance can result in damage due to error function or friction.

##### 4.1 Handle and lock

- When drilling into the door leaf to mount the fittings, take care not to drill into the lock cases. The functioning of the lock could be negatively affected. Please therefore remove the shavings before mounting the fittings. DIN 18251 locks are mounted as standard, with openings to take fittings per DIN 18255. With a 3-point lock the lock must be removed before starting to drill.

- The fine-pitch thread screws on the door handle set create a tremendous force, which could cause the lock case to contract. Lightly drive in the screws to secure the fittings, using a manual screwdriver. Tightening them too hard can cause dents or cracks in the surface finish and affect the function of the lock.

- Take care not to force or jam the lock cylinder and handle shafts when mounting.
- Lock plate screws should not be tightened using a cordless screwdriver.
- The clearance between lock plate and striking plate should be 2-5 mm.

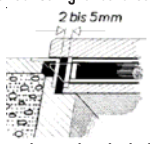

- If the mortise lock is replaced with one of another make, the lock case recess may need to be recaulked to ensure the new lock functions perfectly.

- Do not carry the door leaf by the handle.

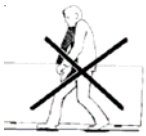

- Do not lock the door when it is open, as the lock mechanics can be damaged by the bolt striking against the frame. A damaged lock should be replaced without delay.



- Do not press the handle and use the key simultaneously.



- Do not turn the handle with a force of more than 150 N (15 kg).

- Do not paint over the locking elements.

- Lubricate locks at least once a year. Remove excess lubricant without delay.

- Do not force double-leaf doors over the inactive leaf.

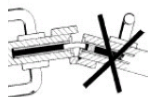

#### 5. Notes and recommendations

When masking the doors and frame (e.g. for painting purposes) please follow the manufacturer's directions for use of the masking tape. The wrong masking tape could cause the surface finish to peel off in places.

Damage (e.g. tears on surface and edges) caused by improper fitting such as replaning, sawing etc., is not covered by our guarantee.

Improper usage or mounting can lead to the following damage or injury:

- Abrasion of the floor by lowered door leaves
- Metal abrasion caused by unserviced or damaged hinges
- Damage to the door and frame through extreme stress (children playing, gusts of wind slamming the door)
- Risk of crushing in rebate and through floor gap
- Injury caused by broken glass (normal Float glass). We recommend using tempered glass (ESG)

##### 5.1 Timber reacts to moisture

Timber is a natural product with its own characteristics and qualities. It reacts to changes in humidity by swelling and warping. Door and frame should be exposed to as few fluctuations in humidity as possible. We therefore advise against installing in rooms with more than 60% relative humidity (take note of humidity in new buildings).

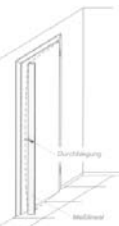

When installing in new buildings: Raised building moisture and premature installation can result in the above climatic levels being exceeded in new buildings. This can temporarily cause increased warping, even with appropriate doors. In this case you should check

the distortion after an entire heating period has elapsed, as experience has shown that warping reduces as the relative humidity lowers. To assess the distortion of installed doors, reference is made to the RAL quality assurance statutes which allow a maximum warping of 4mm. This is on the condition that the doors are suitable for the thermal conditions where they are installed, and the element is not subject to any special demands.

## 6. Maintenance of door elements

Basically, doors and frames do not require any special treatment. If required, squirt a little washing-up liquid or mild cleaner into handwarm water. Take care when selecting a cleaner that it does not contain any abrasive, strong or alcoholic (water-soluble) solvents. Use a damp, lint-free cloth to wipe over the surface finish. Regardless of surface finish, please note the following:

- Never leave the surface wet or damp for any extended period of time, as timber absorbs water and can become warped.
- Wipe any damp or wet spots dry without delay, using an absorbent cloth.
- Do not use furniture polish. Some cleaners and polishes can leave unsightly, greasy smears on the surface finish.
- Do not press too hard when wiping clean, to avoid shiny spots.
- In smoking areas, avoid build-up of yellow nicotine stains on edges, architraves, seals, etc. by cleaning regularly.

Please also see our hints on the internet at [www.huga.de](http://www.huga.de).

### 6.1 HUGA Durat

Regular care:

Wipe surfaces with a damp (not wet) cloth or shammy leather, and then dry with another cloth.

Cleaning normal household dirt:

„Spray HUGA-clean onto a clean, soft cotton cloth and wipe the soiled areas. Work in the direction of the grain, as much as possible. Touch up residues in pores and grooves by spraying directly onto the surface and wiping off; finish off with a dry, lint-free cotton cloth. If necessary polish off again.“

Cleaning heavy-duty dirt:

For stains such as lacquer, felt pen, glue residues, which HUGA-clean cannot shift, we recommend HUGAFLOOR combination stain remover.

Please note:

The edge regions (abutting edges) should not be treated with either HUGA-clean or with other cleaning agents containing alcohol. As the DURAT surface finish is fully sealed, it needs no polish, oil, wax or other furniture care products.

### 6.2 Veneered timber finishes

Timber is a natural product. Each tree is a one-off as regards its growth, colour and grain. Differences can occur even within a single tree-trunk. These singular characteristics are certificates of authenticity and an expression of the natural vitality of timber. In the same way, it is a natural process when UV rays cause changes over time in the colour of veneers. You should always bear this in mind when you select doors for their pattern, or add to existing door elements at a later date. This is the difference between timber and other, perfectly faithful reproductions. These changes are normal and are not grounds for complaint.

### 6.3 Unfinished products

All unfinished products which leave our factory have been rough-ground and must, where appropriate, be reground. Pay special attention to glue spots. These also cannot be avoided in the pores of some types of timber. The glue used does not react to the usual commercial water stain. We therefore recommend using dyes and stains made of organic solvents, or using levelling agents.

Sample stain all components.

In the top horizontal rebate there is a synthetic edge as standard, which cannot be completely colour-matched.

### 6.4 HUGA Karat

The affordable KARAT surface finish is produced from decorative paper partly-treated with resin. Each door is additionally impregnated and finished with a special functional paint. Do not use furniture polish or other products which could leave smears on the finish. Some products could leave unsightly spots or marks on the surface finish.

## 6. Further information on ‚Interior Doors‘

Ifz Information: ‚Interior doors correctly mounted‘, ‚Warping of interior doors, ‚The sound-absorbing door‘  
[www.ifz-rosenheim.de](http://www.ifz-rosenheim.de) or [www.guetegemeinschaft-innentueren.de](http://www.guetegemeinschaft-innentueren.de).  
These directives reflect the current state of technological development.